

1:500 location plan

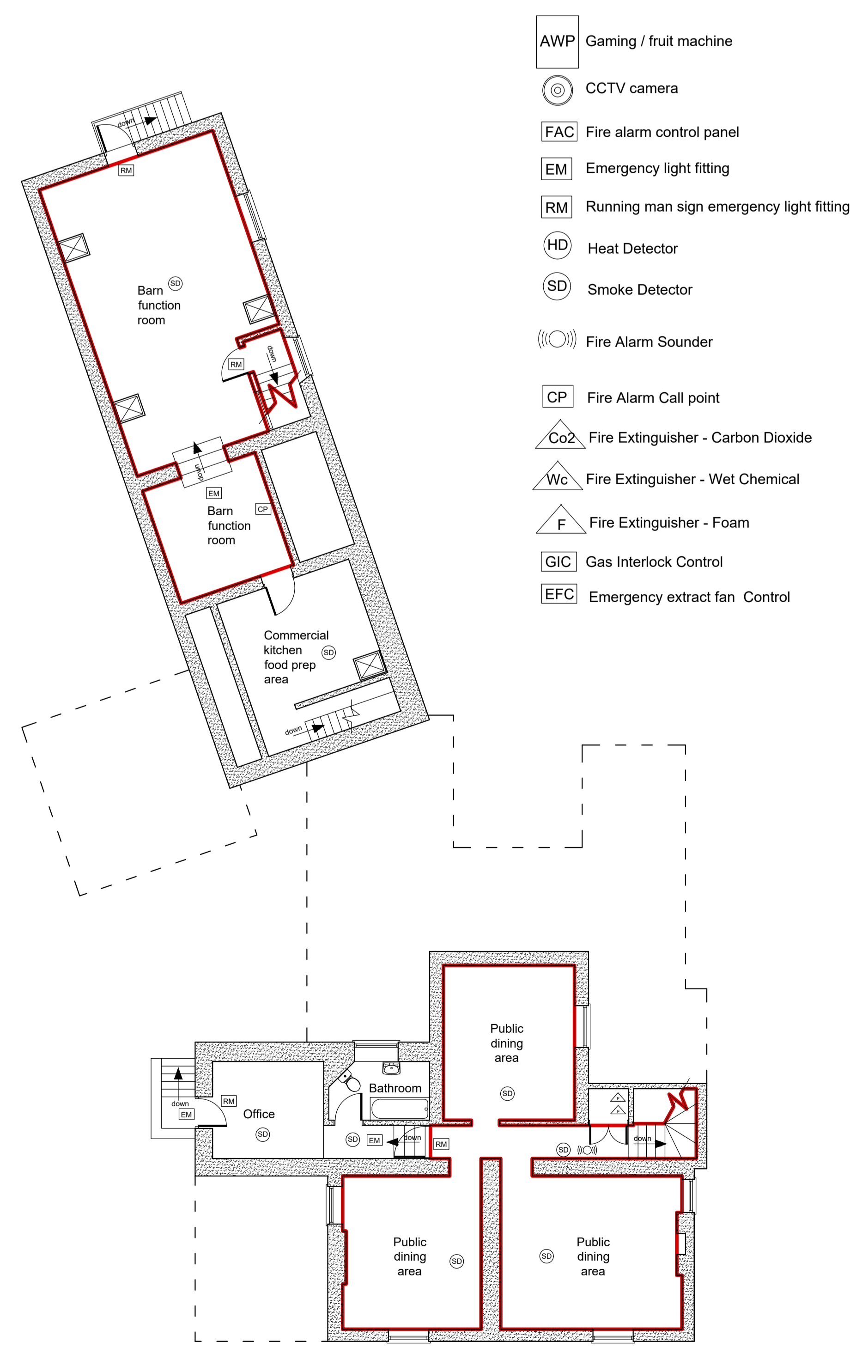

1:100 First floor plan

1:100 Ground floor plan including outside areas.

- AWP Gaming / fruit machine
- CCTV CCTV camera
- FAC Fire alarm control panel
- EM Emergency light fitting
- RM Running man sign emergency light fitting
- HD Heat Detector
- SD Smoke Detector
- S Fire Alarm Sounder
- CP Fire Alarm Call point
- Co2 Fire Extinguisher - Carbon Dioxide
- Wc Fire Extinguisher - Wet Chemical
- F Fire Extinguisher - Foam
- GIC Gas Interlock Control
- EFC Emergency extract fan Control

Rev A 12/01/21 - EDA red line updated - JR

| | | | |
|-------------|---------|--------------------------------------|------|
| CLIENT | | Punch Pubs | |
| PROJECT | | Elm Tree, Elinton, Worksop, S80 4LS. | |
| DRAWING NO. | | Licence Plan | |
| SCALE | DATE | DATE | DATE |
| 1:100 @ A3 | Nov 21 | | |
| DESIGNER | CHECKED | PROJECT NO. | |
| JR | JR | G21 - 9323 - 01 A | |

Southamption 02380 820110